

High Performance Industrial Identification / Safety Identification

B-580 Indoor/Outdoor Vinyl:

- Brady's indoor/outdoor grade vinyl tape adheres well to pipes, walls, equipment, windows – most clean, dry surfaces.
- Conforms well to irregular, curved or rough surfaces – it even stands up to grease, oil and most industrial chemicals.
- Five year average outdoor durability in temperatures from 82°C to -40°C, can be applied as low as -18°C.

Diagram	Order Reference	Width A (mm)	Length B (m)	Colour
●	M71C-500-580-WT	12.70	15.24	White
●	M71C-500-580-YL	12.70	15.24	Yellow
●	M71C-500-580-GN	12.70	15.24	Green
●	M71C-500-580-RD	12.70	15.24	Red
●	M71C-500-580-BL	12.70	15.24	Blue
●	M71C-500-580-LB	12.70	15.24	Light Blue
●	M71C-500-580-SB	12.70	15.24	Sky Blue
●	M71C-500-580-OR	12.70	15.24	Orange
●	M71C-500-580-BK	12.70	15.24	Black
●	M71C-500-580-GY	12.70	15.24	Grey
●	M71C-500-580-BR	12.70	15.24	Brown
●	M71C-500-580-GD	12.70	15.24	Gold
●	M71C-500-580-OC	12.70	15.24	Ochre
●	M71C-500-580-PL	12.70	15.24	Purple
●	M71C-500-580-PK	12.70	15.24	Pink
●	M71C-500-580-TN	12.70	15.24	Tan
●	M71C-500-580-CL	12.70	15.24	Clear
●	M71C-1000-580-WT	25.40	15.24	White
●	M71C-1000-580-YL	25.40	15.24	Yellow
●	M71C-1000-580-GN	25.40	15.24	Green
●	M71C-1000-580-RD	25.40	15.24	Red
●	M71C-1000-580-BL	25.40	15.24	Blue
●	M71C-1000-580-LB	25.40	15.24	Light Blue
●	M71C-1000-580-SB	25.40	15.24	Sky Blue
●	M71C-1000-580-OR	25.40	15.24	Orange
●	M71C-1000-580-BK	25.40	15.24	Black
●	M71C-1000-580-GY	25.40	15.24	Grey
●	M71C-1000-580-BR	25.40	15.24	Brown
●	M71C-1000-580-GD	25.40	15.24	Gold
●	M71C-1000-580-OC	25.40	15.24	Ochre
●	M71C-1000-580-PL	25.40	15.24	Purple
●	M71C-1000-580-PK	25.40	15.24	Pink
●	M71C-1000-580-TN	25.40	15.24	Tan
●	M71C-1000-580-CL	25.40	15.24	Clear
●	M71C-2000-580-WT	50.80	15.24	White
●	M71C-2000-580-YL	50.80	15.24	Yellow
●	M71C-2000-580-GN	50.80	15.24	Green
●	M71C-2000-580-RD	50.80	15.24	Red
●	M71C-2000-580-BL	50.80	15.24	Blue
●	M71C-2000-580-LB	50.80	15.24	Light Blue
●	M71C-2000-580-SB	50.80	15.24	Sky Blue
●	M71C-2000-580-OR	50.80	15.24	Orange
●	M71C-2000-580-BK	50.80	15.24	Black
●	M71C-2000-580-GY	50.80	15.24	Grey
●	M71C-2000-580-BR	50.80	15.24	Brown
●	M71C-2000-580-GD	50.80	15.24	Gold
●	M71C-2000-580-OC	50.80	15.24	Ochre
●	M71C-2000-580-PL	50.80	15.24	Purple
●	M71C-2000-580-PK	50.80	15.24	Pink
●	M71C-2000-580-TN	50.80	15.24	Tan
●	M71C-2000-580-CL	50.80	15.24	Clear

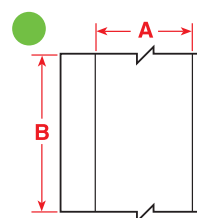

Order references with "C" (e.g. M71C) indicate continuous.

General and Industrial Identification Labels

Repositionable Labels

• B-581 Repositionable Vinyl:

- Special adhesive allows easy removal of label to re-apply again and again.
- Best choice for indoor marking where frequent repositioning is required, such as shelves.

Diagram	Order Reference	Width A (mm)	Length B (m)	Colour
●	M71C-500-581-YI	12.70	15.24	Yellow
●	M71C-500-581-WT	12.70	15.24	White
●	M71C-1000-581-YL	25.40	15.24	Yellow
●	M71C-1000-581-WT	25.40	15.24	White
●	M71C-2000-581-YL	50.80	15.24	Yellow
●	M71C-2000-581-WT	50.80	15.24	White

Order references with "C" (e.g. M71C) indicate continuous.

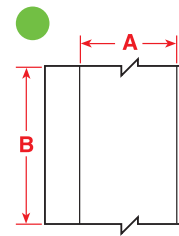

Reflective Labels

• B-584 Reflective Vinyl:

- Ideal for reading labels in low light conditions.

Diagram	Order Reference	Width A (mm)	Length B (m)	Colour
●	M71C-500-584-YI	12.70	15.24	Yellow
●	M71C-500-584-WT	12.70	15.24	White
●	M71C-1000-584-YL	25.40	15.24	Yellow
●	M71C-1000-584-WT	25.40	15.24	White
●	M71C-2000-584-YL	50.80	15.24	Yellow
●	M71C-2000-584-WT	50.80	15.24	White

Order references with "C" (e.g. M71C) indicate continuous.

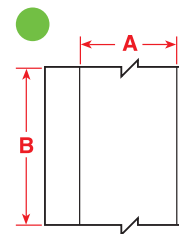

For more information on our materials or to help you choose, visit www.bradyeurope.com

General and Industrial Identification Labels

Material to Surface Cross Reference Guide				Smooth (Examples: Uncoated Metal, Plastic, Glass)	Textured/Rough (Examples: Textured ABS, Cast Metal, Polycarbonate)	Highly Textured / Low Surface Energy (Examples: Powder Coated, Low Surface Energy ABS, Polypropylene)
B-7351	B-352**	B-422*	B-432*	✓ YES	✓ YES	NO
B-435*	B-427**	B-580		✓ YES	✓ YES	NO
B-483*	B-486*	B-489*	B-499*	✓ YES	✓ YES	✓ YES
B-423*	B-424	B-428*	B-430*	✓ YES	NO	NO
B-459*	B-473*	B-488*	B-7546*	✓ YES	NO	NO
B-7566	B-7576*					

*Material UL recognised / CSA approved

**Material UL recognised

Rating, Name Plate Labels

- B-422, B-423 Permanent Glossy Polyester
- B-424 General Purpose White Paper
- B-428 Permanent Metallised Polyester
- B-430 Permanent Clear Polyester
- B-483 Ultra-Aggressive Glossy Polyester
- B-486 Ultra-Aggressive Metallised Polyester
- B-489 Ultra-Aggressive Matt Polyester
- B-488 Matt Polyester
- B-499 Nylon Cloth

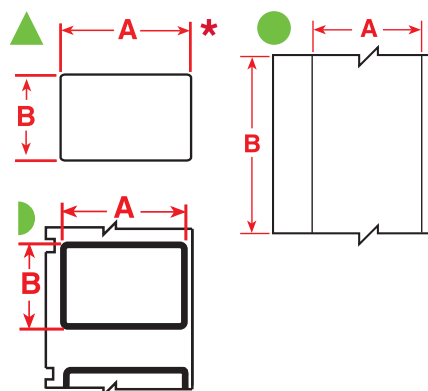

Diagram	Order Reference	Labels Per Roll	Width A (mm)	Height B (mm)	Applications/ Descriptions	Max. Characters per line for 5 Points	Max. Lines of Text for 5 Points	Surface Suitability
▲	M71-16-483	500	25.40	9.53	Asset ID for textured surfaces	24	3	✓
▲	BM71-17-428	5000	25.40	12.70	General Purpose over-laminated ID	24	5	✓
▲	M71-17-428	500	25.40	12.70	General Purpose over-laminated ID	24	5	✓
▲	M71-17-483	500	25.40	12.70	Asset ID for textured surfaces	24	5	✓
▲	M71-17-486	500	25.40	12.70	Asset ID for oily, greasy and textured surfaces	24	5	✓
▲	M71-17-489	500	25.40	12.70	Asset ID for oily, greasy and textured surfaces	24	5	✓
▲	M71-19-423	250	25.40	25.40	Rating plate	24	10	✓
▲	BM71-19-423	2500	25.40	25.40	Rating plate	24	10	✓
▲	M71-19-483	250	25.40	25.40	Asset ID for textured surfaces	24	10	✓
▲	M71-20-424	100	50.80	25.40	General ID and Asset ID	46	10	✓
▲	BM71-20-424	1000	50.80	25.40	General ID and Asset ID	46	10	✓
▲	M71-20-428	100	50.80	25.40	Asset ID, silver finish	46	10	✓
▲	BM71-20-428	1000	50.80	25.40	Asset ID, silver finish	46	10	✓
▲	M71-20-483	100	50.80	25.40	Asset ID for textured surfaces	46	10	✓
▲	M71-20-486	100	50.80	25.40	Asset ID for oily, greasy and textured surfaces	46	10	✓
▲	M71-22-423	100	76.20	25.40	General ID	50	10	✓
▲	M71-22-428	100	76.20	25.40	Rating plate	50	10	✓
▲	M71-23-423	100	101.60	25.40	General ID	50	9	✓
▲	M71-23-483	100	101.60	25.40	Asset ID for textured surfaces	50	9	✓
▶	M71-24-423-BK	500	28.70	12.70	1.60 mm Black-bordered component ID	24	3	✓
▲	M71-26-423	100	69.85	31.75	General ID and Asset ID	50	13	✓
▲	M71-26-428	100	69.85	31.75	General ID and Asset ID	50	13	✓
▲	M71-29-428	500	38.10	12.70	Face plates, panels, equipment, silver finish	37	5	✓

*Any label 50.80 mm or larger is rotated on liner

Order references beginning with "B" indicate bulk rolls.

Continued on next page >>

✓ Material suitable for smooth surfaces.

✓ Material suitable for smooth and textured surfaces.

✓ Material suitable for smooth, textured and highly textured surfaces.

General and Industrial Identification Labels

Rating, Name Plate Labels (continued)

- B-422, B-423 Permanent Glossy Polyester
- B-428 Permanent Metallised Polyester
- B-430 Permanent Clear Polyester
- B-483 Ultra-Aggressive Glossy Polyester
- B-486 Ultra-Aggressive Metallised Polyester
- B-489 Ultra-Aggressive Matt Polyester
- B-488 Matt Polyester
- B-499 Nylon Cloth

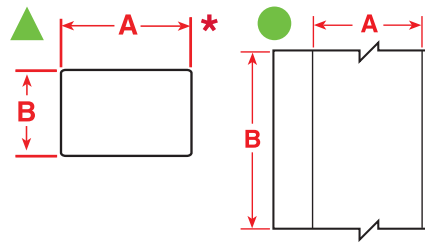

Diagram	Order Reference	Labels Per Roll	Width A (mm)	Height B (mm)	Applications/ Descriptions	Max. Characters per line for 5 Points	Max. Lines of Text for 5 Points	Surface Suitability
▲	M71-29-483	500	38.10	12.70	Asset ID for textured surfaces	37	5	✓
▲	M71-29-486	500	38.10	12.70	Asset ID for oily, greasy and textured surfaces	37	5	✓
▲	M71-29-489	500	38.10	12.70	Asset ID for oily, greasy and textured surfaces	37	5	✓
▲	M71-30-422	250	38.10	19.05	Asset ID for textured surfaces	37	8	✓
▲	M71-30-483	250	38.10	19.05	Asset ID for oily, greasy and textured surfaces	37	8	✓
▲	M71-30-486	250	38.10	19.05	Asset ID for oily, greasy and textured surfaces	37	8	✓
▲	M71-30-499	250	19.05	38.10	Asset ID for oily, greasy and textured surfaces	18	16	✓
▲	M71-31-423	250	38.10	25.40	General ID	37	10	✓
▲	M71-31-483	250	38.10	25.40	Asset ID for textured surfaces	37	10	✓
▲	M71-32-423	250	38.10	38.10	General ID	37	16	✓
▲	M71-32-489	250	38.10	38.10	Asset ID for oily, greasy and textured surfaces	37	16	✓
▲	M71-37-422	100	76.20	48.26	Asset ID for textured surfaces	50	20	✓
▲	M71-37-423	100	76.20	48.26	General ID and Asset ID	50	20	✓
▲	M71-37-483	100	76.20	48.26	Asset ID for oily, greasy and textured surfaces	50	20	✓
▲	M71-37-486	100	76.20	48.26	Asset ID for oily, greasy and textured surfaces	50	20	✓
▲	M71-38-423	100	101.60	48.26	General ID and Asset ID	50	20	✓
▲	M71-38-428	100	101.60	48.26	Asset ID, silver finish	50	20	✓
▲	M71-38-483	100	101.60	48.26	Asset ID for oily, greasy and textured surfaces	50	20	✓
▲	M71-38-489	100	101.60	48.26	Asset ID for oily, greasy and textured surfaces	50	20	✓
▲	M71-78-499	250	48.26	25.40	General ID	46	10	✓
▲	M71-80-488	250	19.05	22.86	Asset ID with print durability	18	10	✓
▲	M71-81-488	750	48.26	6.35	Asset ID with print durability	46	10	✓
▲	M71-81-499	750	48.26	6.35	General ID	46	10	✓
▲	M71-84-499	500	22.86	12.70	General ID	22	2	✓
▲	M71-97-488	250	22.86	22.86	Asset ID with print durability	18	9	✓
●	M71C-375-422	1 (cont.)	9.53	15.24 m	General ID	50	3	✓
●	M71C-375-430	1 (cont.)	9.53	15.24 m	General ID	50	3	✓
●	M71C-475-422	1 (cont.)	12.07	15.24 m	General ID	50	5	✓
●	M71C-500-423	1 (cont.)	12.70	15.24 m	Small ICs	50	5	✓
●	M71C-500-428	1 (cont.)	12.70	15.24 m	Small ICs, silver finish	50	5	✓
●	M71C-500-483	1 (cont.)	12.70	15.24 m	Small IC's, silver finish	50	5	✓
●	M71C-625-422	1 (cont.)	15.88	15.24 m	General ID	50	6	✓
●	M71C-1000-422	1 (cont.)	25.40	15.24 m	General ID	50	10	✓
●	M71C-1000-430	1 (cont.)	25.40	15.24 m	General ID	50	5	✓
●	M71C-1000-483	1 (cont.)	25.40	15.24 m	General ID	50	10	✓
●	M71C-1900-422	1 (cont.)	48.26	15.24 m	General ID	50	10	✓
●	M71C-1900-430	1 (cont.)	48.26	15.24 m	General ID	50	10	✓
●	M71C-1900-483	1 (cont.)	48.26	15.24 m	General ID	50	10	✓

*Any label 50.80 mm or larger is rotated on liner

✓ Material suitable for smooth surfaces.

✓ Material suitable for smooth and textured surfaces.

✓ Material suitable for smooth, textured and highly textured surfaces.

General and Industrial Identification Labels

General Industrial Labels

- B-422 Permanent Glossy Polyester
- B-430 Permanent Clear Polyester
- B-483 Ultra-Aggressive Glossy Polyester
- B-489 Ultra-Aggressive Matt Polyester
- B-580 Indoor/Outdoor Vinyl

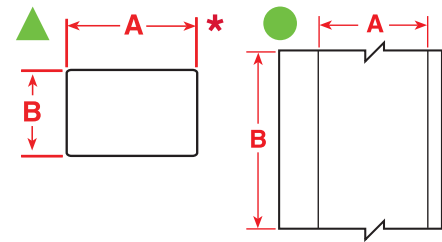

Diagram	Order Reference	Labels Per Roll	Colour	Width A (mm)	Height B (mm)	Max. Characters per line for 7 points	Max. Lines of Text for 7 points	Surface Suitability
▲	M71-16-483	500	White	25.40	9.53	14	2	✓
▲	M71-17-483	500	White	25.40	12.70	10	2	✓
▲	M71-17-489	500	White	25.40	12.70	10	2	✓
▲	M71-19-483	250	White	25.40	25.40	14	7	✓
▲	M71-20-483	100	White	50.80	25.40	50	4	✓
▲	M71-23-483	100	White	101.60	25.40	38	4	✓
▲	M71-29-483	500	White	38.10	12.70	14	2	✓
▲	M71-29-489	500	White	38.10	12.70	14	2	✓
▲	M71-30-422	250	White	38.10	19.05	14	3	✓
▲	M71-30-483	250	White	38.10	19.05	14	3	✓
▲	M71-31-483	250	White	38.10	25.40	14	4	✓
▲	M71-32-489	250	White	38.10	38.10	14	4	✓
▲	M71-37-422	100	White	76.20	48.26	28	9	✓
▲	M71-37-483	100	White	76.20	48.26	28	9	✓
▲	M71-38-483	100	White	101.60	48.26	38	9	✓
▲	M71-38-489	100	White	101.60	48.26	39	9	✓
●	M71C-375-422	1 (cont.)	White	9.53	15.24 m	50	2	✓
●	M71C-375-430	1 (cont.)	Clear	9.53	15.24 m	50	2	✓
●	M71C-475-422	1 (cont.)	White	12.07	15.24 m	50	2	✓
●	M71C-500-422	1 (cont.)	White	12.07	15.24 m	50	2	✓
●	M71C-500-483	1 (cont.)	White	12.70	15.24 m	50	2	✓
●	M71C-500-580-BK	1 (cont.)	Black	12.70	15.24 m	50	2	✓
●	M71C-500-580-BL	1 (cont.)	Blue	12.70	15.24 m	50	2	✓
●	M71C-500-580-BR	1 (cont.)	Brown	12.70	15.24 m	50	2	✓
●	M71C-500-580-CL	1 (cont.)	Clear	12.70	15.24 m	50	2	✓
●	M71C-500-580-GD	1 (cont.)	Gold	12.70	15.24 m	50	2	✓
●	M71C-500-580-GN	1 (cont.)	Green	12.70	15.24 m	50	2	✓
●	M71C-500-580-GY	1 (cont.)	Grey	12.70	15.24 m	50	2	✓
●	M71C-500-580-LB	1 (cont.)	Light Blue	12.70	15.24 m	50	2	✓
●	M71C-500-580-OC	1 (cont.)	Ochre	12.70	15.24 m	50	2	✓
●	M71C-500-580-OR	1 (cont.)	Orange	12.70	15.24 m	50	2	✓
●	M71C-500-580-PK	1 (cont.)	Pink	12.70	15.24 m	50	2	✓
●	M71C-500-580-PL	1 (cont.)	Purple	12.70	15.24 m	50	2	✓
●	M71C-500-580-RD	1 (cont.)	Red	12.70	15.24 m	50	2	✓
●	M71C-500-580-SB	1 (cont.)	Sky Blue	12.70	15.24 m	50	2	✓
●	M71C-500-580-TN	1 (cont.)	Tan	12.70	15.24 m	50	2	✓
●	M71C-500-580-WT	1 (cont.)	White	12.70	15.24 m	50	2	✓
●	M71C-500-580-YL	1 (cont.)	Yellow	12.70	15.24 m	50	2	✓
●	M71C-625-422	1 (cont.)	White	15.88	15.24 m	50	3	✓
●	M71C-1000-580-BK	1 (cont.)	Black	25.40	15.24 m	50	5	✓
●	M71C-1000-580-BL	1 (cont.)	Blue	25.40	15.24 m	50	5	✓
●	M71C-1000-580-BR	1 (cont.)	Brown	25.40	15.24 m	50	5	✓
●	M71C-1000-580-CL	1 (cont.)	Clear	25.40	15.24 m	50	5	✓
●	M71C-1000-580-GD	1 (cont.)	Gold	25.40	15.24 m	50	5	✓
●	M71C-1000-580-GN	1 (cont.)	Green	25.40	15.24 m	50	5	✓
●	M71C-1000-580-GY	1 (cont.)	Grey	25.40	15.24 m	50	5	✓
●	M71C-1000-580-LB	1 (cont.)	Light Blue	25.40	15.24 m	50	5	✓



*Any label 50.80 mm or larger is rotated on liner

Continued on next page >>

✓ Material suitable for smooth surfaces.

✓ Material suitable for smooth and textured surfaces.

✓ Material suitable for smooth, textured and highly textured surfaces.

General and Industrial Identification Labels

General Industrial Labels (continued)

- B-422 Permanent Glossy Polyester
- B-430 Permanent Clear Polyester
- B-483 Ultra-Aggressive Glossy Polyester
- B-580 Indoor/Outdoor Vinyl

Diagram	Order Reference	Labels Per Roll	Colour	Width A (mm)	Height B (mm)	Max. Characters per line for 7 points	Max. Lines of Text for 7 points	Surface Suitability
●	M71C-1000-580-OC	1 (cont.)	Ochre	25.40	15.24 m	50	5	✓
●	M71C-1000-580-OR	1 (cont.)	Orange	25.40	15.24 m	50	5	✓
●	M71C-1000-580-PK	1 (cont.)	Pink	25.40	15.24 m	50	5	✓
●	M71C-1000-580-PL	1 (cont.)	Purple	25.40	15.24 m	50	5	✓
●	M71C-1000-580-RD	1 (cont.)	Red	25.40	15.24 m	50	5	✓
●	M71C-1000-580-SB	1 (cont.)	Sky Blue	25.40	15.24 m	50	5	✓
●	M71C-1000-580-TN	1 (cont.)	Tan	25.40	15.24 m	50	5	✓
●	M71C-1000-580-WT	1 (cont.)	White	25.40	15.24 m	50	5	✓
●	M71C-1000-580-YL	1 (cont.)	Yellow	25.40	15.24 m	50	5	✓
●	M71C-1000-422	1 (cont.)	White	25.40	15.24 m	50	5	✓
●	M71C-1000-430	1 (cont.)	Clear	25.40	15.24 m	50	5	✓
●	M71C-1000-483	1 (cont.)	White	25.40	15.24 m	50	5	✓
●	M71C-1900-422	1 (cont.)	White	48.26	15.24 m	50	9	✓
●	M71C-1900-430	1 (cont.)	Clear	48.26	15.24 m	50	9	✓
●	M71C-1900-483	1 (cont.)	White	48.26	15.24 m	50	9	✓
●	M71C-2000-580-BK	1 (cont.)	Black	50.80	15.24 m	50	8	✓
●	M71C-2000-580-BL	1 (cont.)	Blue	50.80	15.24 m	50	8	✓
●	M71C-2000-580-BR	1 (cont.)	Brown	50.80	15.24 m	50	8	✓
●	M71C-2000-580-CL	1 (cont.)	Clear	50.80	15.24 m	50	8	✓
●	M71C-2000-580-GD	1 (cont.)	Gold	50.80	15.24 m	50	8	✓
●	M71C-2000-580-GN	1 (cont.)	Green	50.80	15.24 m	50	8	✓
●	M71C-2000-580-GY	1 (cont.)	Grey	50.80	15.24 m	50	8	✓
▲	M71C-2000-580-LB	1 (cont.)	Light Blue	50.80	15.24 m	50	8	✓
▲	M71C-2000-580-OC	1 (cont.)	Ochre	50.80	15.24 m	50	8	✓
●	M71C-2000-580-OR	1 (cont.)	Orange	50.80	15.24 m	50	8	✓
●	M71C-2000-580-PK	1 (cont.)	Pink	50.80	15.24 m	50	8	✓
●	M71C-2000-580-PL	1 (cont.)	Purple	50.80	15.24 m	50	8	✓
●	M71C-2000-580-RD	1 (cont.)	Red	50.80	15.24 m	50	8	✓
●	M71C-2000-580-SB	1 (cont.)	Sky Blue	50.80	15.24 m	50	8	✓
●	M71C-2000-580-TN	1 (cont.)	Tan	50.80	15.24 m	50	8	✓
●	M71C-2000-580-WT	1 (cont.)	White	50.80	15.24 m	50	8	✓
●	M71C-2000-580-YL	1 (cont.)	Yellow	50.80	15.24 m	50	8	✓

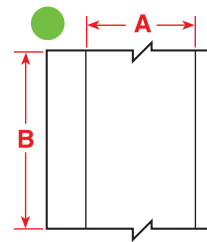

Pre-Printed Labels

- B-423 Permanent Glossy Polyester
- B-428 Permanent Metallised Polyester

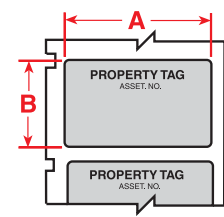
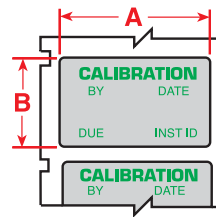
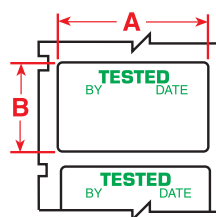

Order Reference	Labels Per Roll	Colours	Width A (mm)	Height B (mm)	Pre-Printed Legend	Surface Suitability
M71-30-423-TEST	250	Green on White	38.10	19.05	Tested	✓
M71-30-428-CALI	250	Green on Silver	38.10	19.05	Calibration	✓
M71-35-428-PROP	250	Black on Silver	41.40	19.05	Property Tag	✓

✓ Material suitable for smooth surfaces.

✓ Material suitable for smooth and textured surfaces.

✓ Material suitable for smooth, textured and highly textured surfaces.

Wire and Cable Marking

Wrap Around Labels

- **B-498 Vinyl cloth:** repositionable rubber based adhesive
- **B-499 Nylon Cloth:** permanent adhesive, pliable for rough and smooth surfaces.

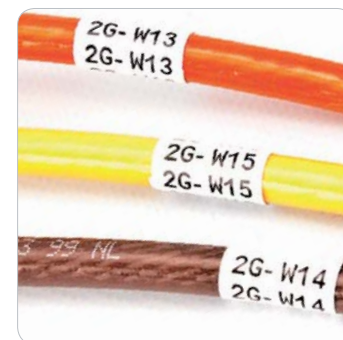
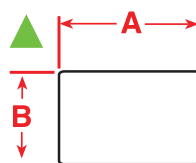

Diagram	Order Reference	Labels Per Roll	Label Width A (mm)	Label Height B (mm)	Max. Wire Diameter (mm)	Approx. Wire Gauge*	Max. Characters per line for 5 Points	Max. Lines of Text for 5 Points
9 AWG Based on Type of Wire – Max Wire Diam. 3.03 mm								
▲	M71-7-498	500	12.70	12.70	3.03	9	11	5
▲	M71-7-499	500	12.70	12.70	3.03	9	11	5
▲	M71-81-499	750	48.26	6.35	10.00	9	46	10
▲	M71-84-499	500	22.86	12.70	6.00	9	22	2
6 AWG Based on Type of Wire – Max Wire Diam. 4.55 mm								
▲	M71-10-498	750	6.35	19.05	4.55	6	5	3
▲	M71-11-498	500	12.70	19.05	4.55	6	11	8
▲	BM71-11-498	5000	12.70	19.05	4.55	6	11	8
▲	M71-11-499	500	12.70	19.05	4.55	6	11	8
▲	BM71-11-499	5000	12.70	19.05	4.55	6	11	8
3 AWG Based on Type of Wire – Max Wire Diam. 6.06 mm								
▲	M71-16-498	500	9.53	25.40	6.06	3	8	10
▲	M71-16-499	500	9.53	25.40	6.06	3	8	10
▲	M71-17-498	500	25.40	12.70	6.06	3	24	5
▲	M71-18-498	250	19.05	25.40	6.06	3	18	10
▲	M71-18-499	250	19.05	25.40	6.06	3	18	10
▲	BM71-18-498	2500	19.05	25.40	6.06	3	18	10
▲	M71-19-498	250	25.40	25.40	6.06	3	24	10
▲	BM71-19-498	2500	25.40	25.40	6.06	3	24	10
▲	M71-19-499	250	25.40	25.40	6.06	3	24	10
▲	M71-78-499	250	48.26	25.40	10.00	3	46	10
0 AWG Based on Type of Wire – Max Wire Diam. 9.10 mm								
▲	M71-28-499	750	38.10	6.35	9.10	0	5	16
▲	M71-29-498	500	38.10	12.70	9.10	0	11	16
▲	BM71-29-498	5000	12.70	38.10	9.10	0	11	16
▲	M71-29-499	500	12.70	38.10	9.10	0	11	16
▲	M71-30-498	250	19.05	38.10	9.10	0	18	16
▲	M71-30-499	250	19.05	38.10	9.10	0	18	16
▲	M71-31-498	250	25.40	38.10	9.10	0	24	16
▲	M71-31-499	250	25.40	38.10	9.10	0	24	16
▲	M71-32-498	250	38.10	38.10	9.10	0	37	16
0000 AWG Based on Type of Wire – Max Wire Diam. 15.16 mm								
▲	M71-21-498	100	25.40	63.50	15.6	0000	24	23
▲	M71-21-499	100	25.40	63.50	15.6	0000	24	23
0000 AWG Based on Type of Wire – Max Wire Diam. 24.26 mm								
▲	M71-33-498	100	38.10	101.60	24.26	0000	37	16

*Based on National Electric Code insulation measurement of THHN Wire.

Order references beginning with "B" indicate bulk rolls.

Wire and Cable Marking

Self-Laminating Labels

- **B-427 Vinyl:** resistant to water, oil, solvents and abrasion.
- **B-642 Tedlar®:** excellent abrasion and smudge resistance, self-extinguishing

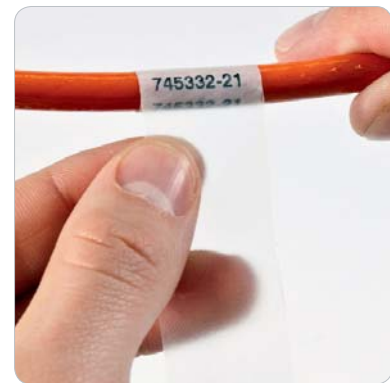
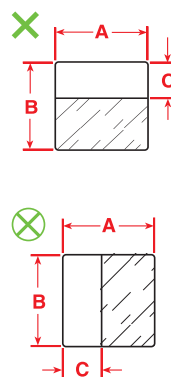

Diagram	Order Reference	Labels Per Roll	Colour	Label Width A (mm)	Label Height B (mm)	Write-on Height C (mm)	Min. Wire Diameter (mm)	Max. Wire Diameter (mm)	Approx. Wire Gauge*	Max. Characters per line for 5 Points	Max. Lines of Text for 5 Points
10 to 0 AWG Based on Type of Wire – Maximum Wire Diam 10.00											
✗	M71-104-427	250	White	38.10	25.40	9.53	3.00	8.00	10 to 0	37	3
10 to 4 AWG Based on Type of Wire – Maximum Wire Diam 5.00											
⊗	BM71-17-427	5000	White	12.70	25.40	9.53	3.00	5.00	10 to 4	11	3
⊗	M71-17-427	500	White	12.70	25.40	9.53	3.00	5.00	10 to 4	11	3
⊗	BM71-18-427	2500	White	19.05	25.40	9.53	3.00	5.00	10 to 4	18	3
⊗	M71-18-427	250	White	19.05	25.40	9.53	3.00	5.00	10 to 4	18	3
✗	BM71-19-427	2500	White	25.40	25.40	9.53	3.00	5.00	10 to 4	24	3
✗	M71-19-427	250	White	25.40	25.40	9.53	3.00	5.00	10 to 4	24	3
✗	M71-19-427-YL	250	Yellow	25.40	25.40	9.53	3.00	5.00	10 to 4	24	3
✗	M71-19-642	250	White	25.40	25.40	9.53	3.00	5.00	10 to 4	24	3
✗	M71-96-427	250	White	25.40	19.05	9.53	3.00	5.00	10 to 4	24	3
10 to 10 AWG Based on Type of Wire – Maximum Wire Diam 3.00											
⊗	M71-10-427	750	White	6.35	19.05	9.53	3.00	3.00	10 to 10	5	3
⊗	BM71-11-427	5000	White	12.70	19.05	9.53	3.00	3.00	10 to 10	11	3
⊗	M71-11-427	500	White	12.70	19.05	9.53	3.00	3.00	10 to 10	11	3
7 to 0000 AWG Based on Type of Wire – Maximum Wire Diam 12.00											
⊗	BM71-107-427	1000	White	50.80	38.10	12.70	4.00	12.00	7 to 0000	46	5
⊗	M71-107-427	100	White	50.80	38.10	12.70	4.00	12.00	7 to 0000	46	5
7 to 0000 AWG Based on Type of Wire – Maximum Wire Diam 10.00											
✗	M71-88-427	250	White	44.45	38.10	12.70	4.00	10.00	7 to 0000	40	5
7 to 0 AWG Based on Type of Wire – Maximum Wire Diam 8.00											
⊗	M71-28-427	750	White	6.35	38.10	12.70	4.00	8.00	7 to 0	5	5
⊗	BM71-29-427	5000	White	12.70	38.10	12.70	4.00	8.00	7 to 0	11	5
⊗	M71-29-427	500	White	12.70	38.10	12.70	4.00	8.00	7 to 0	11	5
⊗	BM71-30-427	2500	White	19.05	38.10	12.70	4.00	8.00	7 to 0	18	5
⊗	M71-30-427	250	White	19.05	38.10	12.70	4.00	8.00	7 to 0	18	5
⊗	M71-30-427-BL	250	Blue	19.05	38.10	12.70	4.00	8.00	7 to 0	18	5
⊗	M71-30-427-PL	250	Purple	19.05	38.10	12.70	4.00	8.00	7 to 0	18	5
⊗	M71-30-427-RD	250	Red	19.05	38.10	12.70	4.00	8.00	7 to 0	18	5
⊗	BM71-31-427	2500	White	25.40	38.10	12.70	4.00	8.00	7 to 0	24	5
⊗	M71-31-427	250	White	25.40	38.10	12.70	4.00	8.00	7 to 0	24	5
⊗	M71-31-427-GN	250	Green	25.40	38.10	12.70	4.00	8.00	7 to 0	24	5
⊗	M71-31-427-RD	250	Red	25.40	38.10	12.70	4.00	8.00	7 to 0	24	5
⊗	M71-31-427-YL	250	Yellow	25.40	38.10	12.70	4.00	8.00	7 to 0	24	5
⊗	M71-31-642	250	White	25.40	38.10	12.70	4.00	8.00	7 to 0	24	5
⊗	BM71-32-427	1000	White	38.10	38.10	12.70	4.00	8.00	7 to 0	37	5
⊗	M71-32-427	250	White	38.10	38.10	12.70	4.00	8.00	7 to 0	37	5
⊗	M71-32-427-YL	250	Yellow	38.10	38.10	12.70	4.00	8.00	7 to 0	37	5
7 to 4 AWG Based on Type of Wire – Maximum Wire Diam 5.00											
✗	M71-103-427	250	White	25.40	31.75	12.70	4.00	5.00	7 to 4	24	5

*Based on National Electric Code insulation measurement of THHN Wire.

Order references beginning with "B" indicate bulk rolls.

Continued on next page >>

Self-Laminating Labels (continued)

- **B-427 Vinyl:** resistant to water, oil, solvents and abrasion.
- **B-642 Tedlar®:** excellent abrasion and smudge resistance, self-extinguishing

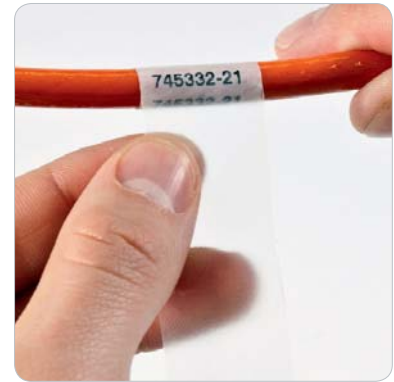
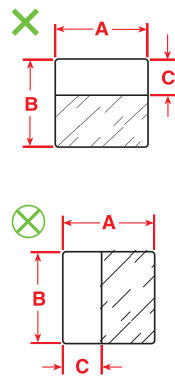

Diagram	Order Reference	Labels Per Roll	Colour	Label Width A (mm)	Label Height B (mm)	Write-on Height C (mm)	Min. Wire Diameter (mm)	Max. Wire Diameter (mm)	Approx. Wire Gauge*	Max. Characters per line for 5 Points	Max. Lines of Text for 5 Points
3 to 0000 AWG Based on Type of Wire – Maximum Wire Diam 14.00											
⊗	BM71-21-427	1000	White	25.40	63.50	19.05	6.00	14.00	3 to 0000	24	8
⊗	M71-21-427	100	White	25.40	63.50	19.05	6.00	14.00	3 to 0000	24	8
⊗	M71-21-427-YL	100	Yellow	25.40	63.50	19.05	6.00	14.00	3 to 0000	24	8
⊗	M71-21-642	100	White	25.40	63.50	19.05	6.00	14.00	3 to 0000	24	8
1 to 0000 AWG Based on Type of Wire – Maximum Wire Diam 24.00											
⊗	BM71-23-427	1000	White	25.40	101.60	25.40	8.00	24.00	1 to 0000	24	10
⊗	M71-23-427	100	White	25.40	101.60	25.40	8.00	24.00	1 to 0000	24	10
⊗	BM71-33-427	500	White	38.10	101.60	25.40	8.00	24.00	1 to 0000	37	10
⊗	M71-33-427	100	White	38.10	101.60	25.40	8.00	24.00	1 to 0000	37	10
⊗	M71-33-427-YL	100	Yellow	38.10	101.60	25.40	8.00	24.00	1 to 0000	37	10
1 to 0000 AWG Based on Type of Wire – Maximum Wire Diam 17.00											
⊗	BM71-34-427	500	White	38.10	152.40	38.10	8.00	17.00	1 to 0000	37	16
⊗	M71-66-427	100	White	49.23	80.01	25.40	8.00	17.00	1 to 0000	46	10
1 to 0000 AWG Based on Type of Wire – Maximum Wire Diam 36.00											
⊗	M71-34-427	50	White	38.10	152.40	38.10	12.00	36.00	1 to 0000	37	16
1 to 0000 AWG Based on Type of Wire – Maximum Wire Diam 20.00											
⊗	BM71-109-427	500	White	38.10	101.60	38.10	12.00	20.00	1 to 0000	37	16
⊗	M71-109-427	100	White	38.10	101.60	38.10	12.00	20.00	1 to 0000	37	16
1 to 0000 AWG Based on Type of Wire – Maximum Wire Diam 17.00											
⊗	BM71-64-427	1000	White	25.40	85.73	28.58	9.00	17.00	1 to 0000	24	12
⊗	M71-64-427	100	White	25.40	85.73	28.58	9.00	17.00	1 to 0000	24	12

*Based on National Electric Code insulation measurement of THHN Wire.

Order references beginning with "B" indicate bulk rolls.

Applying Self-laminating Labels



Apply the printed area to your wire.



Wrap the clear area around the wire, covering the printed area.

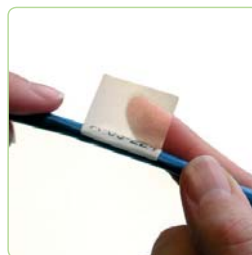

Once applied the clear laminate will protect your legend for years to come.

Wire and Cable Marking

PermaSleeve™ Heat-Shrink Sleeve Markers

- **B-342 Polyolefin:** 3:1 Shrink ratio, self-extinguishing, meets requirements of SAE AMS-DTL-23053/5 Class 1, SAE-AS-81531, MIL-STD-202 method 215K, is UL224 recognised, CSA acceptance pending
- **B-341 Polyolefin:** 2:1 Shrink ratio, same properties as B-342

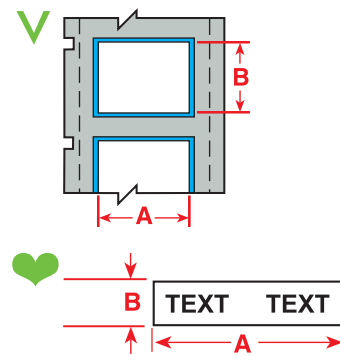

Diagram	Order Reference	Sleeves Per Roll	Colour	Sleeve Width A (mm)	Sleeve Height B (mm)	Min. Wire Diameter (mm)	Max. Wire Diameter (mm)	Approx. Wire Gauge*	Max. Characters per line for 5 Points	Max. Lines of Text for 5 Points
3:1 SHRINK RATIO										
25.78mm marker width										
✓	M71-94-1-342	100	White	25.78	4.62	0.58	2.03	28 to 18	22	1
✓	BM71-94-1-342	2500	White	25.78	4.62	0.58	2.03	28 to 18	22	1
✓	M71-94-1-342YL	100	Yellow	25.78	4.62	0.58	2.03	28 to 18	22	1
✓	BM71-94-1-342YL	2500	Yellow	25.78	4.62	0.58	2.03	28 to 18	22	1
✓	M71-125-1-342	100	White	25.78	5.97	1.17	2.79	22 to 16	22	1
✓	BM71-125-1-342	1000	White	25.78	5.97	1.17	2.79	22 to 16	22	1
✓	M71-125-1-342YL	100	Yellow	25.78	5.97	1.17	2.79	22 to 16	22	1
✓	BM71-125-1-342YL	1000	Yellow	25.78	5.97	1.17	2.79	22 to 16	22	1
✓	M71-187-1-342	100	White	25.78	8.51	1.57	3.81	18 to 12	22	2
✓	BM71-187-1-342	1000	White	25.78	8.51	1.57	3.81	18 to 12	22	2
✓	M71-187-1-342YL	100	Yellow	25.78	8.51	1.57	3.81	18 to 12	22	2
✓	BM71-187-1-342YL	1000	Yellow	25.78	8.51	1.57	3.81	18 to 12	22	2
✓	M71-250-1-342	100	White	25.78	11.15	2.39	5.46	16 to 10	22	3
✓	BM71-250-1-342	1000	White	25.78	11.15	2.39	5.46	16 to 10	22	3
✓	M71-250-1-342YL	100	Yellow	25.78	11.15	2.39	5.46	16 to 10	22	3
✓	BM71-250-1-342YL	1000	Yellow	25.78	11.15	2.39	5.46	16 to 10	22	3
✓	M71-375-1-342	100	White	25.78	16.38	3.18	8.13	12 to 6	22	5
✓	BM71-375-1-342	1000	White	25.78	16.38	3.18	8.13	12 to 6	22	5
✓	M71-375-1-342YL	100	Yellow	25.78	16.38	3.18	8.13	12 to 6	22	5
✓	BM71-375-1-342YL	1000	Yellow	25.78	16.38	3.18	8.13	12 to 6	22	5
✓	M71-500-1-342	100	White	25.78	21.62	4.75	11.43	8 to 1	22	7
✓	BM71-500-1-342	1000	White	25.78	21.62	4.75	11.43	8 to 1	22	7
✓	M71-500-1-342YL	100	Yellow	25.78	21.62	4.75	11.43	8 to 1	22	7
✓	BM71-500-1-342YL	1000	Yellow	25.78	21.62	4.75	11.43	8 to 1	22	7
44.83mm marker width										
✓	M71-94-175-342	100	White	44.83	4.62	0.58	2.03	28 to 18	41	1
✓	BM71-94-175-342	2500	White	44.83	4.62	0.58	2.03	28 to 18	41	1
✓	M71-94-175-342YL	100	Yellow	44.83	4.62	0.58	2.03	28 to 18	41	1
✓	BM71-94-175-342YL	2500	Yellow	44.83	4.62	0.58	2.03	28 to 18	41	1
✓	M71-125-175-342	100	White	44.83	5.97	1.17	2.79	22 to 16	41	1
✓	BM71-125-175-342	1000	White	44.83	5.97	1.17	2.79	22 to 16	41	1
✓	M71-125-175-342YL	100	Yellow	44.83	5.97	1.17	2.79	22 to 16	41	1
✓	BM71-125-175-342YL	1000	Yellow	44.83	5.97	1.17	2.79	22 to 16	41	1
✓	M71-187-175-342	100	White	44.83	8.51	1.57	3.81	18 to 12	41	3
✓	BM71-187-175-342	1000	White	44.83	8.51	1.57	3.81	18 to 12	41	3
✓	M71-187-175-342YL	100	Yellow	44.83	8.51	1.57	3.81	18 to 12	41	3
✓	BM71-187-175-342YL	1000	Yellow	44.83	8.51	1.57	3.81	18 to 12	41	3
✓	M71-250-175-342	100	White	44.83	11.15	2.39	5.46	16 to 10	41	3
✓	BM71-250-175-342	1000	White	44.83	11.15	2.39	5.46	16 to 10	41	3
✓	M71-250-175-342YL	100	Yellow	44.83	11.15	2.39	5.46	16 to 10	41	3
✓	BM71-250-175-342YL	1000	Yellow	44.83	11.15	2.39	5.46	16 to 10	41	3
✓	M71-375-175-342	100	White	44.83	16.38	3.18	8.13	12 to 6	41	5
✓	BM71-375-175-342	1000	White	44.83	16.38	3.18	8.13	12 to 6	41	5
✓	M71-375-175-342YL	100	Yellow	44.83	16.38	3.18	8.13	12 to 6	41	5
✓	BM71-375-175-342YL	1000	Yellow	44.83	16.38	3.18	8.13	12 to 6	41	5
✓	M71-500-175-342	100	White	44.83	21.62	4.75	11.43	8 to 1	41	7
✓	BM71-500-175-342	1000	White	44.83	21.62	4.75	11.43	8 to 1	41	7
✓	M71-500-175-342YL	100	Yellow	44.83	21.62	4.75	11.43	8 to 1	41	7
✓	BM71-500-175-342YL	1000	Yellow	44.83	21.62	4.75	11.43	8 to 1	41	7
Continuous marker										
♥	BM71C-125-342	1 (cont.)	White	15.24 m	5.97	1.17	2.79	22 to 16	NA	NA
♥	BM71C-187-342	1 (cont.)	White	15.24 m	8.51	1.57	3.81	18 to 12	NA	NA
♥	BM71C-250-342	1 (cont.)	White	15.24 m	11.15	2.39	5.46	16 to 10	NA	NA
♥	BM71C-375-342	1 (cont.)	White	15.24 m	16.38	3.18	8.13	12 to 6	NA	NA
♥	BM71C-500-342	1 (cont.)	White	15.24 m	21.62	4.75	11.43	8 to 1	NA	NA
2:1 SHRINK RATIO										
25.78mm marker width										
✓	M71-1000-1-341	50	White	25.78	42.16	11.43	24.13	1 to 500	22	16
✓	M71-1000-1-341YL	50	Yellow	25.78	42.16	11.43	24.13	1 to 500	22	16
44.83mm marker width										
✓	M71-1000-175-341	50	White	44.83	42.16	11.43	24.13	1 to 500	41	16
✓	BM71-1000-175-341	500	White	44.83	42.16	11.43	24.13	1 to 500	41	16
✓	M71-1000-175-341YL	50	Yellow	44.83	42.16	11.43	24.13	1 to 500	41	16
Continuous marker										
♥	BM71C-1000-341	1 (cont.)	White	15.24 m	42.16	11.43	24.13	1 to 500	NA	NA

*Based on National Electric Code insulation measurement of THHN Wire.

Order references beginning with "B" indicate bulk rolls.

Rigid Durasleeve Inserts

- **B-7696:** Rigid vinyl tag

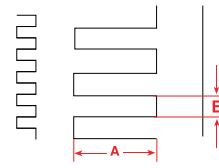

Order Reference	Tags Per Roll	Colour	Width (mm)	Height (mm)	Carrier	Max. Characters per line for 5 Points	Max. Lines of Text for 5 Points
BM71D-3-7696	2500	White	16.00	4.40	AC*-L16	11	1
BM71D-3-7696-YL	5000	Yellow	16.00	4.40	AC*-L16	11	1
BM71D-5-7696	2500	White	30.00	4.40	AC*-L30	21	1
BM71D-5-7696-YL	5000	Yellow	30.00	4.40	AC*-L30	21	1

Order references beginning with "B" indicate bulk rolls.

Ademark Tag Carrier

Ademark carriers are produced in transparent PVC. The special shape of the carrier means that it can be adapted to cables of various diameters. This means that there are only seven different sizes of carriers which cater for cables with external diameters from 1.3 mm up to 24 mm.

- Temperature range: -40° to 60°C
- Material: PVC
- Self extinguishing: UL94V0



Order Reference	Carriers per pack	Length (mm)	Wire O.D. (mm)
AC-0-L16	2000	16.00 mm	1.30 - 2.00
AC-1-L16	2000	16.00 mm	1.80 - 2.50
AC-2-L16	2000	16.00 mm	2.50 - 4.00
AC-3-L16	1000	16.00 mm	4.00 - 6.50
AC-4-L16	1000	16.00 mm	6.00 - 10.00
AC-5-L16	750	16.00 mm	9.00 - 15.00
AC-6-L16	500	16.00 mm	15.00 - 24.00

Order Reference	Carriers per pack	Length (mm)	Wire O.D. (mm)
AC-0-L30	2000	30.00 mm	1.30 - 2.00
AC-1-L30	2000	30.00 mm	1.80 - 2.50
AC-2-L30	2000	30.00 mm	2.50 - 4.00
AC-3-L30	1000	30.00 mm	4.00 - 6.50
AC-4-L30	1000	30.00 mm	6.00 - 10.00
AC-5-L30	750	30.00 mm	9.00 - 15.00
AC-6-L30	500	30.00 mm	15.00 - 24.00

Rapido™

- **B-7599:** Yellow coated polyethylene tag suitable for durable terminated wire marking for electrical devices and fibre installations.

Order Reference	Tags Per Roll	Colour	Width A (mm)	Height B (mm)	Max. Characters per line for 5 Points	Max. Lines of Text for 5 Points
BM71R-1-7599-YL	2500	Yellow	22.90	5.20	11	1
BM71R-2-7599-YL	2500	Yellow	23.00	5.20	8	1
BM71R-3-7599-YL	2500	Yellow	25.00	5.70	7	2
BM71R-4-7599-YL	2500	Yellow	26.00	7.00	7	2
BM71R-5-7599-YL	2500	Yellow	41.00	11.00	17	3

Order references beginning with "B" indicate bulk rolls.

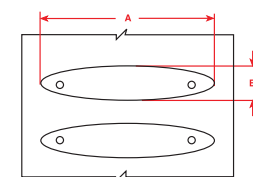

Wire and Cable Marking

Heatex™ Cable Markers

- **B-7643:** Zero halogen polyether polyurethane tag material

Order Reference	Tags Per Roll	Colour	Width A (mm)	Height B (mm)	Max. Characters per line for 5 Points	Max. Lines of Text for 5 Points
BM71H-1-7643-WT	250	White	60.00	10.00	40	4
BM71H-1-7643-YL	250	Yellow	60.00	10.00	40	4
BM71H-2-7643-WT	250	White	75.00	10.00	51	4
BM71H-2-7643-YL	250	Yellow	75.00	10.00	51	4
BM71H-3-7643-WT	250	White	75.00	25.00	51	10
BM71H-3-7643-YL	250	Yellow	75.00	25.00	51	10

Order references beginning with "B" indicate bulk rolls.

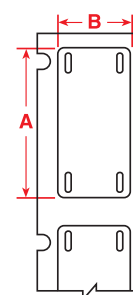

Tear Resistant Cable Markers

- **B-109 Polyethylene:** Provides extreme tear resistance and excellent cold-weather performance; meets requirements of DIN VDE 0472/parts 815
- **B-145 Polyethylene:** Tear resistant and 2-side printable, is UL94 V2 recognised

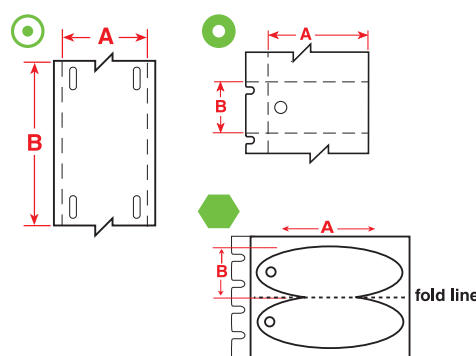
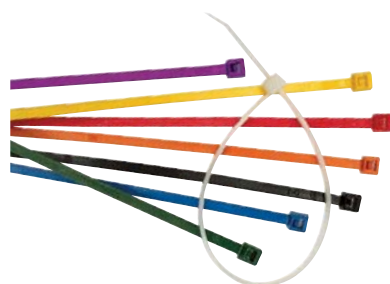

Diagram	Order Reference	Tags Per Roll	Colour	Width A (mm)	Height B (mm)	Write-on Area W x H (mm)	Max. Characters per line for 5 Points	Max. Lines of Text for 5 Points	Cable Type
⊙	M71-12-109	100	White	19.05	76.20	17.78 x 52.07	45	6	Cable Bundles; Power & Ground Cables
⊙	BM71-12-109	1,000	White	19.05	76.20	17.78 x 52.07	45	6	Cable Bundles
●	M71-36-109	250	White	44.45	28.58	44.45 x 28.57	40	15	Power & Ground Cables
⬠	BM71-111-145-GY	1,000	Grey	19.25	30.63	19.25 x 30.63	16	14	145C Tag; Power & Ground Cables
⬠	BM71-110-145-GY	1,000	Grey	44.45	25.40	44.45 x 25.40	28	20	145P Tag; Power & Ground Cables

Order references beginning with "B" indicate bulk rolls.



Coloured Nylon Ties

Perfect for colour coded applications.

Size: 200 x 4 mm

Material: Nylon

Packing: 100 pieces

Order Reference	Colour	Order Reference	Colour
229955	White	229959	Yellow
229956	Blue	229960	Green
229957	Red	229961	Violet
229958	Orange	229962	Black

BL	Blue, for horizontal cable terminations
BR	Brown, for campus backbone cable terminations
GR	Green, network connections
GY	Grey, for backbone cable between intermediate cross-connect and telecommunications cabinet
OR	Orange, central office termination
PL	Purple, major switching and data equipment terminations
RD	Red, for all key telephone equipment terminations
YL	Yellow, for auxiliary, maintenance, alarms, security, etc.

Terminal Block Repositionable Markers

- **B-498:** Repositionable vinyl cloth

Order Reference	Label Width A (mm)	Label Length B (m) (continuous)	Max. Characters per line for 5 Points
M71C-240-498	6.10	9.14	4
M71C-318-498	8.08	9.14	7
BM71C-318-498	8.08	91.44	7
M71C-375-498	9.53	9.14	7
BM71C-375-498	9.53	91.44	7

Order references beginning with "B" indicate bulk rolls.
Order references with "C" (e.g. M71C) indicate continuous.

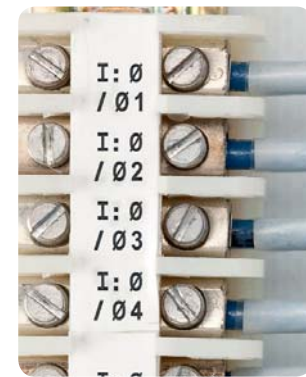
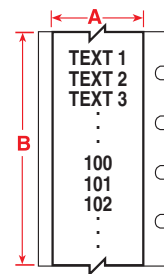

EPREP Labels – Engraved Plate Replacement Labels

- **B-7593:** Polyethylene Foam Laminate

BRADY EPREP labels are innovative labels specifically designed to replace engraved and plotted plates for identification of electrical components, electrical cabinets, push buttons, patch panels etc.

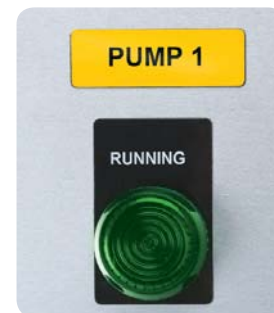

Roll

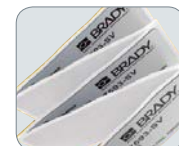

Fanfolded

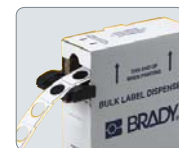

Bulk roll

Diagram	Order Reference	Tags Per Roll	Colour	Width A (mm)	Height B (mm)	Diameter D (mm)	Max. Characters per line for 5 Points	Max. Lines of Text for 5 Points	Format
▲	M71EP-1-7593-SL	250	Silver	27.00	8.00		22	3	Roll
▲	M71EP-1-7593-WT	250	White	27.00	8.00		22	3	Roll
▲	M71EP-2-7593-SL	250	Silver	27.00	12.50		22	5	Roll
▲	M71EP-2-7593-WT	250	White	27.00	12.50		22	5	Roll
▲	M71EP-3-7593-SL	150	Silver	27.00	15.00		22	6	Roll
▲	M71EP-3-7593-WT	150	White	27.00	15.00		22	6	Roll
▲	M71EP-4-7593-SL	150	Silver	27.00	18.00		22	7	Roll
▲	M71EP-4-7593-WT	150	White	27.00	18.00		22	7	Roll
□	M71EP-5-7593-BK	100	Black	30.00	40.00	24.00	24	5	Fanfolded
□	M71EP-5-7593-GN	100	Green	30.00	40.00	24.00	24	5	Fanfolded
□	M71EP-5-7593-RD	100	Black	30.00	40.00	24.00	24	5	Fanfolded
□	M71EP-5-7593-SL	100	Silver	30.00	40.00	24.00	24	5	Fanfolded
□	M71EP-5-7593-WT	100	White	30.00	40.00	24.00	24	5	Fanfolded
□	M71EP-5-7593-YL	100	Yellow	30.00	40.00	24.00	24	5	Fanfolded
▲	M71EP-6-7593-BK	100	Black	45.00	15.00		36	6	Fanfolded
▲	M71EP-6-7593-RD	100	Black	45.00	15.00		36	6	Fanfolded
▲	M71EP-6-7593-YL	100	Yellow	45.00	15.00		36	6	Fanfolded
▲	BM71E-6-7593-SL	500	Silver	45.00	15.00		36	6	Bulk roll
▲	BM71E-6-7593-WT	500	White	45.00	15.00		36	6	Bulk roll
▲	M71EP-7-7593-SL	100	Silver	35.00	18.00		28	7	Roll
▲	M71EP-7-7593-WT	100	White	35.00	18.00		28	7	Roll
▲	M71EP-7-7593-YL	100	Yellow	35.00	18.00		28	7	Roll
▲	M71EP-8-7593-SL	125	Silver	48.00	19.00		39	7	Roll
▲	M71EP-8-7593-WT	125	White	48.00	19.00		39	7	Roll

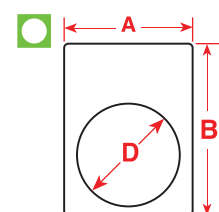
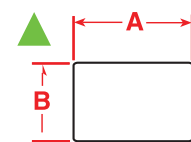

Order references beginning with "B" indicate bulk rolls.

Nylon Cloth Labels

- **B-499:** White nylon cloth with high adhesion

Order Reference	Tags Per Roll	Label Diameter C (mm)	Max. Characters per line for 5 Points	Max. Lines of Text for 5 Points
M71-82-499	500	9.52	7	2
M71-83-499	250	12.70	9	3



Datacom Labels

Self-Laminating Labels

- **B-427 Vinyl:** excellent abrasion and smudge resistance.

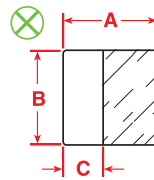
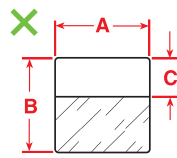

Diagram	Order Reference	Labels Per Roll	Label Width A (mm)	Label Height B (mm)	Write-on Height C (mm)	Application	Max. Characters per line for 5 Points	Max. Lines of Text for 5 Points
✕	BM71-19-427	2500	25.40	25.40	9.53	2 Pair Fibre	24	3
✕	M71-19-427	250	25.40	25.40	9.53	2 Pair Fibre	24	3
✕	M71-19-427-YL	250	25.40	25.40	9.53	2 Pair Fibre	24	3
✕	BM71-21-427	1000	25.40	63.50	19.05	4 Pair STP, 25 Pair Copper, 4-12 Pair Fibre	24	8
✕	M71-21-427	100	25.40	63.50	19.05	4 Pair STP, 25 Pair Copper, 4-12 Pair Fibre	24	8
✕	M71-21-427-YL	100	25.40	63.50	19.05	4 Pair STP, 25 Pair Copper, 4-12 Pair Fibre	24	8
✕	BM71-23-427	1000	25.40	101.60	25.40	50 Pair Copper, 24 Pair Fibre, Backbone cable	24	10
✕	M71-23-427	100	25.40	101.60	25.40	50 Pair Copper, 24 Pair Fibre, Backbone cable	24	10
⊗	BM71-29-427	5000	12.70	38.10	12.70	CAT 5, 4 Pair UTP	11	5
⊗	M71-29-427	500	12.70	38.10	12.70	CAT 5, 4 Pair UTP	11	5
⊗	BM71-30-427	2500	19.05	38.10	12.70	CAT 5, 4 Pair UTP	18	5
⊗	M71-30-427	250	19.05	38.10	12.70	CAT 5, 4 Pair UTP	18	5
⊗	M71-30-427-BL	250	19.05	38.10	12.70	CAT 5, 4 Pair UTP	18	5
⊗	M71-30-427-PL	250	19.05	38.10	12.70	CAT 5, 4 Pair UTP	18	5
⊗	M71-30-427-RD	250	19.05	38.10	12.70	CAT 5, 4 Pair UTP	18	5
⊗	BM71-31-427	2500	25.40	38.10	12.70	4 Pair UTP, CAT 5, CAT 5E, RG-6 Coax, RG-59 Coax	24	5
⊗	M71-31-427	250	25.40	38.10	12.70	4 Pair UTP, CAT 5, CAT 5E, CAT 6, Silver Satin, RG-6 Coax, RG-59 Coax	24	5
⊗	M71-31-427-GN	250	25.40	38.10	12.70	4 Pair UTP, CAT 5, CAT 5E, CAT 6, Silver Satin, RG-6 Coax, RG-59 Coax	24	5
⊗	M71-31-427-RD	250	25.40	38.10	12.70	4 Pair UTP, CAT 5, CAT 5E, CAT 6, Silver Satin, RG-6 Coax, RG-59 Coax	24	5
⊗	M71-31-427-YL	250	25.40	38.10	12.70	4 Pair UTP, CAT 5, CAT 5E, CAT 6, Silver Satin, RG-6 Coax, RG-59 Coax	24	5
⊗	BM71-32-427	1000	38.10	38.10	12.70	CAT 5, 4 Pair UTP	37	5
⊗	M71-32-427	250	38.10	38.10	12.70	CAT 5, 4 Pair UTP	37	5
⊗	M71-32-427-YL	250	38.10	38.10	12.70	CAT 5, 4 Pair UTP	37	5
✕	BM71-33-427	500	38.10	101.60	25.40	50 Pair Copper, 24 Pair Fibre, Backbone cable	37	10
✕	M71-33-427	100	38.10	101.60	25.40	50 Pair Copper, 24 Pair Fibre, Backbone cable	37	10
✕	M71-33-427-YL	100	38.10	101.60	25.40	50 Pair Copper, 24 Pair Fibre, Backbone cable	37	10
✕	BM71-34-427	500	38.10	152.40	38.10	100 Pair Copper, 36 Pair Fibre	37	16
✕	M71-34-427	50	38.10	152.40	38.10	100 Pair Copper	37	16
✕	BM71-64-427	1000	25.40	85.73	28.58	Fibre/Coax	24	12
✕	M71-64-427	100	25.40	85.73	28.58	Fibre/Coax	24	12
✕	M71-66-427	100	49.23	80.01	25.40	50 Pair Copper, 24 Pair Fibre, Backbone cable	46	10
✕	M71-88-427	250	44.45	38.10	12.70	CAT 5, 4 Pair UTP	40	5
✕	M71-103-427	250	25.40	31.75	12.70	CAT 5, 4 Pair UTP	24	5
✕	M71-104-427	250	38.10	25.40	9.53	2 Pair Fibre, Single/Multi-Mode	37	3
✕	BM71-107-427	1000	50.80	38.10	12.70	CAT 5, 4 Pair UTP	46	5
⊗	M71-107-427	100	50.80	38.10	12.70	CAT 5, 4 Pair UTP	46	5
✕	BM71-109-427	500	38.10	101.60	38.10	50 Pair Copper, 24 Pair Fibre, Backbone cable	37	16
✕	M71-109-427	100	38.10	101.60	38.10	50 Pair Copper, 24 Pair Fibre, Backbone cable	37	16

Order references beginning with "B" indicate bulk rolls.

TubeSleeve Carriers

Brady TubeSleeve Carriers are the ideal complement to self-laminating labels, where the cables are thin and available space for text is small. Apply the tubesleeve to the cable and then apply the self-lam. The limited available space is increased significantly, giving you the possibility of printing more text.

Order Reference	Sleeves Per Pack	Min. Cable Diameter (mm)	Max. Cable Diameter (mm)	Recommended Label
BTS1426	1000	1.00	4.00	M71-31-427
BTS4626	1000	4.00	6.00	M71-31-427
BTS6826	400	6.00	8.00	M71-23-423
BTS81226	250	8.00	12.00	M71-23-423



Fibre Optic Labels/Flags

- B-425 Polypropylene

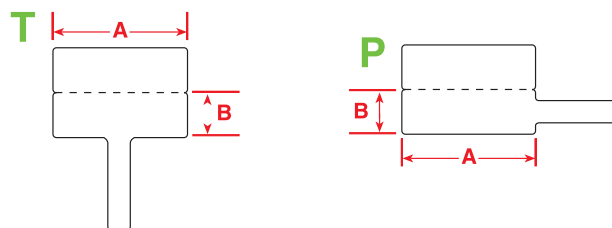

Diagram	Order Reference	Labels Per Roll	Label Width A (mm)	Label Height B (mm)	Application	Max. Characters per line for 5 Points	Max. Lines of Text for 5 Points
T	M71FT-1-425	250	30.00	20.00	Fibre Strand	24	8
P	M71FP-1-425	250	30.00	20.00	Fibre Strand	24	8
P	M71FP-2-425	250	44.45	25.40	Fibre Strand	35	10



Power and Ground Cable Tags

- B-109 Polyethylene: Extreme tear resistance
- B-145 Polyethylene: Tear resistant and 2-side printable
- B145FR Polyethylene: Tear resistant, 2-side printable and flame retardant

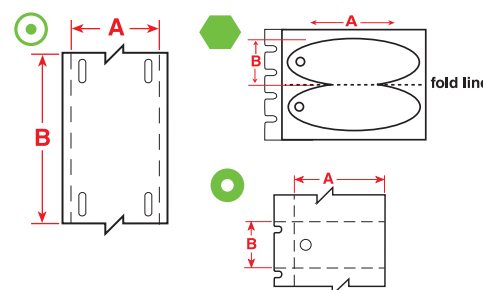

Diagram	Order Reference	Tags Per Roll	Colour	Width A (mm)	Height B (mm)	Write-on Area W x H (mm)	Max. Characters per line for 5 Points	Max. Lines of Text for 5 Points	Application
⊙	BM71-12-109	1000	White	19.05	76.20	17.78 x 52.07	45	6	Communications Cables, Power & Ground Cables
⊙	M71-12-109	100	White	19.05	76.20	17.78 x 52.07	45	6	Communications Cables
⊙	M71-36-109	250	White	44.45	28.58	44.45 x 28.57	40	15	Cable Labels
⬠	BM71-111-145-GY	1000	Grey	30.63	19.25	19.25 x 30.63	16	14	Cable Labels
⬠	M71-111-145FR-GY	100	Grey	30.63	19.25	19.25 x 30.63	16	14	Cable Labels
⬠	M71-111-145-GY	100	Grey	30.63	19.25	19.25 x 30.63	16	14	Cable Labels
⬠	M71-110-145FR-GY	100	Grey	44.45	25.40	44.45 x 25.40	28	20	Cable Labels
⬠	BM71-110-145-GY	1000	Grey	44.45	25.40	44.45 x 25.40	28	20	Cable Labels
⬠	M71-110-145-GY	100	Grey	44.45	25.40	44.45 x 25.40	28	20	Cable Labels

Order references beginning with "B" indicate bulk rolls.

Datacom Labels

Workstation Labels

- B-412 Polypropylene
- B-422 Permanent Glossy Polyester
- B-430 Clear Polyester

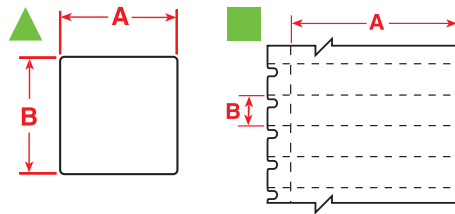

Diagram	Order Reference	Labels Per Roll	Label Width A (mm)	Label Height B (mm)	Application	Max. Characters per line for 5 Points	Max. Lines of Text for 5 Points
▲	M71-16-430	500	25.40	9.53	Location ID, 1-4 Outlet Faceplates	24	3
▲	M71-17-430	500	25.40	12.70	Location ID, 1-4 Outlet Faceplates	24	5
■	BM71-40-412	5000	49.23	9.53	Desi-Strip Inserts	40	3
■	M71-40-412	750	49.23	9.53	Desi-Strip Inserts	40	3
▲	M71-45-422	500	38.10	9.53	Location ID	37	3
▲	M71-45-430	500	38.10	9.53	Location ID	37	3
▲	M71-68-430	750	6.10	3.81	Siemon Faceplates	4	2
▲	M71-71-430	750	8.89	5.08	Siemon Faceplates	7	2

Order references beginning with "B" indicate bulk rolls.

Patch Panel Identification

- B-412 Polypropylene Tag
- B-422 Permanent Glossy Polyester
- B-423 Permanent Polyester
- B-430 Permanent Clear Polyester

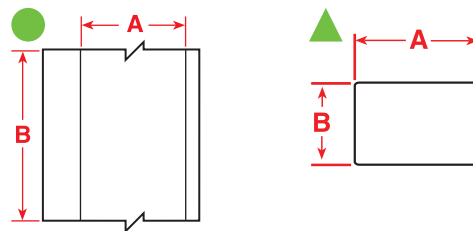

Diagram	Order Reference	Tags Per Roll	Label Width A (mm)	Label Height B (mm)	Application	Max. Characters per line for 5 Points	Max. Lines of Text for 5 Points
▲	M71-10-423	750	19.05	6.35	Patch Panel - ID Port, Voice/Data Identification	18	2
●	M71C-230-412	1 (cont.)	5.84	15.24 m	Broadcast Patch Bay Strips	50	4
●	M71C-375-412	1 (cont.)	9.53	15.24 m	Broadcast Patch Bay Strips	50	3
●	M71C-375-422	1 (cont.)	9.53	15.24 m	Outlet, Pach panel, Cont. Tape, Cut to size	50	3
●	M71C-375-430	1 (cont.)	9.53	15.24 m	Outlet, Pach panel, Cont. Tape, Cut to size	50	3
●	M71C-475-412	1 (cont.)	12.70	15.24 m	Broadcast Patch Bay Strips, Racks& Panels	50	4
●	M71C-500-412	1 (cont.)	12.70	15.24 m	Broadcast Patch Bay Strips	50	5
●	M71C-500-422	1 (cont.)	12.70	15.24 m	Outlet, Pach panel, Cont. Tape, Cut to size	50	5
●	M71C-500-430	1 (cont.)	12.70	15.24 m	Outlet, Pach panel, Cont. Tape, Cut to size	50	5
●	M71C-785-412	1 (cont.)	19.94	15.24 m	Broadcast Patch Bay Strips	50	8



For more information on our materials or to help you choose, visit www.bradyeurope.com

Racks, Panels and General Identification

- B-412 Polypropylene Tag
- B-422 Permanent Glossy Polyester
- B-423 Permanent Polyester
- B-430 Permanent Clear Polyester

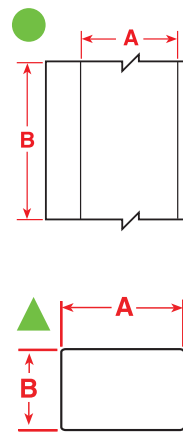

Diagram	Order Reference	Labels Per Roll	Label Width A (mm)	Label Height B (mm)	Application	Max. Characters per line for 5 Points	Max. Lines of Text for 5 Points
▲	BM71-20-422	1000	50.80	25.40	Racks, Panels & General ID	46	10
▲	M71-20-483	100	50.80	25.40	Racks, Panels & General ID	46	10
▲	M71-23-483	100	101.60	25.40	Racks, Panels & General ID	50	9
▲	M71-30-483	250	38.10	19.05	Racks, Panels & General ID	37	8
▲	M71-31-483	250	38.10	25.40	Racks, Panels & General ID	37	10
▲	M71-37-422	100	76.20	48.26	Racks, Panels & General ID	50	20
▲	M71-37-483	100	76.20	48.26	Racks, Panels & General ID	50	20
▲	M71-38-483	100	101.60	48.26	Racks, Panels & General ID	50	20
▲	M71-61-483	100	12.70	50.80	Racks, Panels & General ID	50	5
▲	M71-65-483	250	34.93	25.40	Racks, Panels & General ID	35	10
●	M71C-230-412	1 (cont.)	5.84	15.24 m	Racks, Panels & General ID	50	2
●	M71C-375-412	1 (cont.)	9.53	15.24 m	Racks, Panels & General ID	50	3
●	M71C-375-422	1 (cont.)	9.53	15.24 m	Closet Hardware Labels, Racks, Panels & General ID	50	3
●	M71C-375-430	1 (cont.)	9.53	15.24 m	Closet Hardware Labels, Racks, Panels & General ID	50	3
●	M71C-500-412	1 (cont.)	12.70	15.24 m	Racks, Panels & General ID	50	5
●	M71C-500-422	1 (cont.)	12.70	15.24 m	Racks, Panels & General ID	50	5
●	M71C-500-430	1 (cont.)	12.70	15.24 m	Racks, Panels & General ID	50	5
●	M71C-500-483	1 (cont.)	12.70	15.24 m	Racks, Panels & General ID	50	5
●	M71C-785-412	1 (cont.)	19.94	15.24 m	Racks, Panels & General ID	50	8
●	M71C-1000-422	1 (cont.)	25.40	15.24 m	Racks, Panels & General ID	50	10
●	M71C-1000-430	1 (cont.)	25.40	15.24 m	Racks, Panels & General ID	50	5
●	M71C-1000-483	1 (cont.)	25.40	15.24 m	Racks, Panels & General ID	50	10
●	M71C-1900-483	1 (cont.)	48.26	15.24 m	Racks, Panels & General ID	50	10

Order references beginning with "B" indicate bulk rolls.



Bulk Packaging

Bulk labels are designed for the BMT™71 Label Printer as a cost-effective solution for high volume labelling needs.

Order references beginning with "B" indicate bulk rolls.

Circuit Board and Component Identification Labels

Material to Circuit Board Process Cross Reference Guide

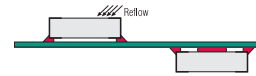
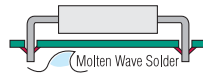

Brady material number (B-number)				Through Hole Technology		Surface Mount Technology (SMT)		After Process
				Top	Bottom	Top or Bottom		
B-426	B-457	B-478	B-479	✓ YES	✓ YES	✓ YES		✓ YES
B-422	B-423	B-428	B-437	✓ YES*	✗ NO	✗ NO		✓ YES
B-459	B-473	B-498*						

*In extreme high temperatures, testing of these materials is recommended.

Polyimides

- **B-426 High Temperature Amber Polyimide:**
Withstands extremely high temperatures
- **B-457 High Temperature White Polyimide:**
good contrast and smear resistance
- **B-477 Static Dissipative Polyimide:**
Static dissipative adhesive and liner
- **B-478 Static Dissipative Polyimide:**
Static dissipative adhesive and liner; low profile

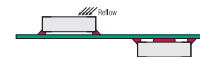
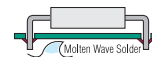
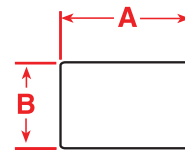

Order Reference	Labels Per Roll	Width A (mm)	Height B (mm)	Max. Characters per line for 5 Points	Max. Lines of Text for 5 Points	Max. Bar Code Characters**	Through Hole Technology		SMT Top/Bottom	After Process
							Top	Bottom		
M71-2-477	100	6.35	50.80	41	2	23*	✓	✓	✓	✓
M71-3-457	500	9.53	9.53	7	3	1	✓	✓	✓	✓
M71-4-478	500	10.16	10.16	8	4	2	✓	✓	✓	✓
M71-9-426	750	16.51	5.08	13	2	5*	✓	✓	✓	✓
M71-9-478	750	16.51	5.08	13	2	5*	✓	✓	✓	✓
M71-10-457	750	19.05	6.35	15	2	6*	✓	✓	✓	✓
M71-13-426	750	22.86	6.35	18	2	8*	✓	✓	✓	✓
M71-14-477	750	25.40	4.75	20	1	10	✓	✓	✓	✓
M71-16-426	500	25.40	9.53	20	4	10	✓	✓	✓	✓
M71-16-457	500	25.40	9.53	20	4	10	✓	✓	✓	✓
M71-17-426	500	25.40	12.70	20	5	10	✓	✓	✓	✓
M71-25-478	750	31.75	6.35	26	2	13*	✓	✓	✓	✓
M71-28-426	750	38.10	6.35	31	2	17*	✓	✓	✓	✓

*No human readable characters below / above barcode

**Values for barcode 128, width 2 Dot, ratio 2:1

Tedlar®

- **B-437 Flame-Retardant White Tedlar®**

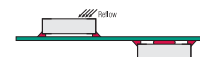
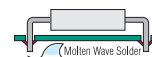
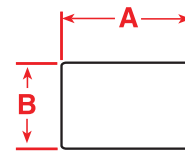

Order Reference	Labels Per Roll	Width A (mm)	Height B (mm)	Max. Characters per line for 5 Points	Max. Lines of Text for 5 Points	Max. Bar Code Characters**	Through Hole Technology		SMT Top/Bottom	After Process
							Top	Bottom		
M71-10-437	750	19.05	6.35	15	2	6*	✓	✗	✗	✓
M71-15-437	750	25.40	6.99	20	2	10*	✓	✗	✗	✓
M71-29-437	500	38.10	12.70	31	5	17	✓	✗	✗	✓

Tedlar® is a registered trademark of DuPont.

*No human readable characters below / above barcode

**Values for barcode 128, width 2 Dot, ratio 2:1

✓ Yes, this material will work with this application.

✗ No, this material does not work with this application.

✓ In extreme high temperatures, testing of these materials is recommended.

Circuit Board and Component Identification Labels

Vinyl Cloth

- **B-498 White Vinyl Cloth:**
with repositionable adhesive

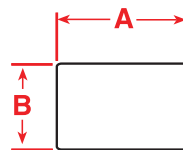

Order Reference	Labels Per Roll	Width A (mm)	Height B (mm)	Max. Characters per line for 5 Points	Max. Lines of Text for 5 Points	Max. Bar Code Characters**	Through Hole Technology		SMT Top/Bottom	After Process
							Top	Bottom		
M71-7-498	500	12.70	12.70	10	5	3	✓	✗	✗	✓
M71-10-498	750	19.05	6.35	15	2	6*	✓	✗	✗	✓
M71-16-498	500	25.40	9.53	20	4	10	✓	✗	✗	✓
M71-17-498	500	25.40	12.70	20	5	10	✓	✗	✗	✓
BM71-29-498	5000	38.10	12.70	31	5	17	✓	✗	✗	✓
M71-29-498	500	38.10	12.70	31	5	17	✓	✗	✗	✓
M71-32-498	250	38.10	38.10	37	16	17	✓	✗	✗	✓

*No human readable characters below / above barcode

**Values for barcode 128, width 2 Dot, ratio 2:1

Order references beginning with "B" indicate bulk rolls.

Polyester

- **B-423, B-459 Permanent White Polyester:**
- **B-428 Permanent Metallised Polyester:**
- **B-473 Static Dissipative Polyester:**
Static dissipative adhesive and liner

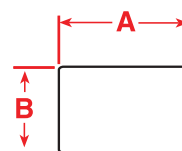

Order Reference	Labels Per Roll	Width A (mm)	Height B (mm)	Max. Characters per line for 5 Points	Max. Lines of Text for 5 Points	Max. Bar Code Characters**	Through Hole Technology		SMT Top/Bottom	After Process
							Top	Bottom		
M71-1-423	750	6.35	6.35	5	2	0	✓	✗	✗	✓
M71-2-423	100	50.80	6.35	41	2	23*	✓	✗	✗	✓
M71-3-423	500	9.53	9.53	7	3	0	✓	✗	✗	✓
M71-4-423	500	10.16	10.16	8	4	0	✓	✗	✗	✓
M71-5-423	750	12.70	5.08	11	1	3	✓	✗	✗	✓
M71-6-423	750	12.70	6.99	11	2	3	✓	✗	✗	✓
M71-6-473	750	12.70	6.99	11	2	3	✓	✗	✗	✓
M71-7-423	500	12.70	12.70	10	5	3	✓	✗	✗	✓
BM71-7-423	5000	12.70	12.70	10	5	3	✓	✗	✗	✓
M71-9-423	750	16.51	5.08	13	2	5*	✓	✗	✗	✓
M71-9-473	750	16.51	5.08	13	2	5*	✓	✗	✗	✓
M71-10-423	750	19.05	6.35	15	2	6*	✓	✗	✗	✓
M71-10-473	750	19.05	6.35	15	2	6*	✓	✗	✗	✓
M71-13-423	750	22.86	6.35	18	2	8*	✓	✗	✗	✓
M71-14-423	750	25.40	4.75	20	1	10	✓	✗	✗	✓
M71-15-423	750	25.40	6.99	20	2	10	✓	✗	✗	✓
M71-15-428	750	25.40	6.99	20	2	10	✓	✗	✗	✓
M71-16-423	500	25.40	9.53	20	4	10	✓	✗	✗	✓
BM71-16-423	5000	25.40	9.53	20	4	10	✓	✗	✗	✓
M71-16-473	500	25.40	9.53	20	4	10	✓	✗	✗	✓
M71-17-423	500	25.40	12.70	20	5	10	✓	✗	✗	✓
BM71-17-423	5000	25.40	12.70	20	5	10	✓	✗	✗	✓
M71-17-428	500	25.40	12.70	20	5	10	✓	✗	✗	✓
M71-17-473	500	25.40	12.70	20	5	10	✓	✗	✗	✓
M71-19-423	250	25.40	25.40	20	10	10	✓	✗	✗	✓
BM71-19-423	2500	25.40	25.40	20	10	10	✓	✗	✗	✓
M71-20-423	100	50.80	25.40	41	10	23	✓	✗	✗	✓
BM71-20-423	1000	50.80	25.40	41	10	23	✓	✗	✗	✓
M71-20-459	100	50.80	25.40	41	10	23	✓	✗	✗	✓
M71-25-423	750	31.75	6.35	26	2	13*	✓	✗	✗	✓
M71-26-423	100	69.85	31.75	57	12	32	✓	✗	✗	✓
M71-27-423	750	38.10	3.18	31	1	17	✓	✗	✗	✓
M71-28-423	750	38.10	6.35	31	2	17	✓	✗	✗	✓
M71-28-473	750	38.10	6.35	31	2	17	✓	✗	✗	✓
M71-29-423	500	38.10	12.70	31	5	17	✓	✗	✗	✓
BM71-29-423	5000	38.10	12.70	31	5	17	✓	✗	✗	✓
M71-29-459	500	38.10	12.70	31	5	17	✓	✗	✗	✓
M71-30-459	250	38.10	19.05	31	8	17	✓	✗	✗	✓
M71-37-423	100	76.20	48.26	60	19	35	✓	✗	✗	✓
M71-38-423	100	101.60	48.26	82	19	47	✓	✗	✗	✓
M71C-500-423	1 (cont.)	12.70	15.24 m	50	5		✓	✗	✗	✓

*No human readable characters below / above barcode

**Values for barcode 128, width 2 Dot, ratio 2:1

Order references beginning with "B" indicate bulk rolls.

✓ Yes, this material will work with this application.

✗ No, this material does not work with this application.

✓ In extreme high temperatures, testing of these materials is recommended.

Security Identification Labels

Tamper Indicating Labels

- B-351 Tamper-Resistant White Vinyl
- B-352 Tamper-Resistant Metallised Vinyl
- B-530 Tamper-Resistant White Vinyl

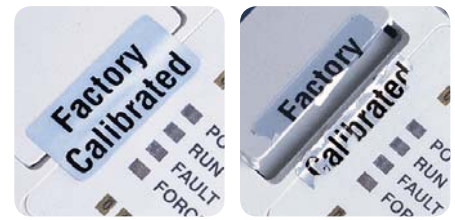
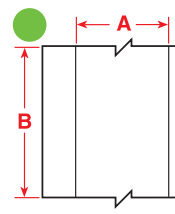
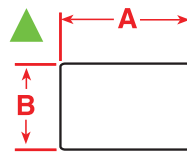

Diagram	Order Reference	Labels Per Roll	Colour	Width A (mm)	Height B (mm)	Max. Characters per line for 5 Points	Max. Lines of Text for 5 Points	Surface Suitability
▲	M71-17-351	500	White	25.40	12.70	20	5	✓
▲	M71-17-352	500	Silver	25.40	12.70	20	5	✓
▲	M71-20-351	100	White	50.80	25.40	46	10	✓
▲	M71-20-352	100	Silver	50.80	25.40	46	10	✓
▲	M71-31-351	250	White	38.10	25.40	37	10	✓
▲	M71-31-352	250	Silver	38.10	25.40	37	10	✓
▲	M71-37-351	100	White	76.20	48.26	50	20	✓
▲	M71-37-352	100	Silver	76.20	48.26	50	20	✓
●	M71C-500-530	1 (cont.)	White	12.70	15.24 m	50	2	✓
●	M71C-1000-530	1 (cont.)	White	25.40	15.24 m	50	5	✓
●	M71C-2000-530	1 (cont.)	White	50.80	15.24 m	50	10	✓

✓ Material suitable for smooth surfaces.

✓ Material suitable for smooth and textured surfaces.

✓ Material suitable for smooth, textured and highly textured surfaces.

Laboratory Identification Labels

F Freezer

N Liquid nitrogen

A Autoclave

H Hot water (100°C) bath

Self-Laminating Labels

- B-427 Vinyl: excellent abrasion and smudge resistance.
- B-461 Polyester: resistant to extreme temperatures (-196°C to 130°C)

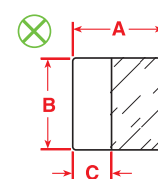
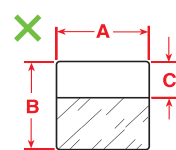

Diagram	Order Reference	Labels Per Roll	Label Width A (mm)	Label Height B (mm)	Write-On Height C (mm)	Environment	Application	Vial/Tube size
✗	M71-19-427	250	25.40	25.40	9.53	F N	Straws	0.25 mL Straw
✗	BM71-19-427	2500	25.40	25.40	9.53	F N	Straws	0.2 5mL Straw
✗	M71-19-427-YL	250	25.40	25.40	9.53	F N	Straws	0.25 mL Straw
✗	M71-21-427	100	25.40	63.50	19.53	F N	Straws	0.5 ml Straw
✗	BM71-21-427	1000	25.40	63.50	19.53	F N	Straws	0.5 ml Straw
✗	M71-21-427-YL	100	25.40	63.50	19.53	F N	Straws	0.5 ml Straw
✗	M71-30-427-AW	250	38.10	19.05	-	F N	Conical Tube, Bottles, Petri Dish, Deep Well Plate	50.0 ml Conical Tube/Bottles/Petri Dish/Deep Well Plate
⊗	BM71-30-427	2500	19.05	38.10	12.70	F N	Conical Tube, Bottles, Petri Dish, Deep Well Plate	50.0 ml Conical Tube/Bottles/Petri Dish/Deep Well Plate
✗	BM71-75-461	1000	66.68	25.40	25.40	F N A H	Cryo Vial	1.0 - 8.0 ml Vial/Tube

AW = All White (no transparent area) – YL = Yellow

Order references beginning with "B" indicate bulk rolls.

Vinyl & Nylon Cloth Labels

- **B-498 Vinyl Cloth:**
repositionable adhesive
- **B-499 Nylon Cloth:**
high adhesion

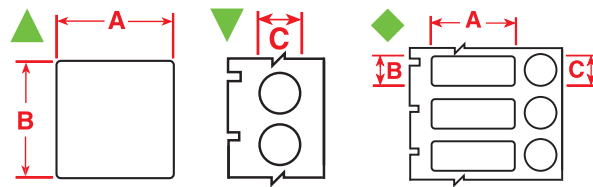

Diagram	Order Reference	Labels Per Roll	Label Width A (mm)	Label Height B (mm)	Label Diameter C (mm)	Environment	Application	Vial/Tube size
▲	M71-11-498	500	12.70	19.05	-	F	Centrifuge, Eppendorf, PCR Tube	0.5 - 0.7ml Tube
▲	BM71-11-498	5000	12.70	19.05	-	F	Centrifuge, Eppendorf, PCR Tube	0.5 - 0.7ml Tube
▲	M71-11-499	500	12.70	19.05	-	F N A	Centrifuge, Eppendorf, PCR Tube, Cryo Vial	0.5 - 0.7ml Tube - 0.6ml Vial/Tube
▲	M71-16-498	500	9.53	25.40	-	F	Centrifuge, Eppendorf, PCR Tube	0.5 - 0.7ml Tube
▲	M71-16-499	500	9.53	25.40	-	F N A	Centrifuge, Eppendorf, PCR Tube	0.5 - 0.7ml Tube
▲	M71-17-498	500	25.40	12.70	-	F	Conical Tube, Bottles, Petri Dish, Deep Well Plate	50.0ml Conical Tube/Bottles/Petri Dish/Deep Well Plate
▲	M71-29-498	500	38.10	12.70	-	F	Conical Tube, Cryo Vial, Bottles, Petri Dish, Deep Well Plate	12.0 - 24.0ml Vial/Tube 50.0ml Conical Tube/Bottles/Petri Dish/Deep Well Plate
▲	BM71-29-498	5000	12.70	38.10	-	F	Cryo Vial, Conical Tube, Bottles, Petri Dish, Deep Well Plate	12.0 - 24.0ml Vial/Tube 50.0ml Conical Tube/Bottles/Petri Dish/Deep Well Plate
▲	M71-29-499	500	12.70	38.10	-	F N A	Conical Tube, Cryo Vial, Bottles, Petri Dish, Deep Well Plate	12.0 - 24.0ml Vial/Tube 50.0ml Conical Tube/Bottles/Petri Dish/Deep Well Plate
▲	M71-30-499	250	19.05	38.10	-	F N A	Conical Tube, Bottles, Petri Dish, Deep Well Plate	50.0ml Conical Tube/Bottles/Petri Dish/Deep Well Plate
▲	M71-31-498	250	25.40	38.10	-	F	Conical Tube, Bottles, Petri Dish, Deep Well Plate	50.0ml Conical Tube/Bottles/Petri Dish/Deep Well Plate
▲	M71-31-499	250	25.40	38.10	-	F N A	Conical Tube, Bottles, Petri Dish, Deep Well Plate	50.0ml Conical Tube/Bottles/Petri Dish/Deep Well Plate
▲	M71-78-499	250	48.26	25.40	-	F N A	Conical Tube, Bottles, Petri Dish, Deep Well Plate	50.0ml Conical Tube/Bottles/Petri Dish/Deep Well Plate
▲	M71-81-499	750	48.26	6.35	-	F N A	Well Plate	
▼	M71-82-499	500	-	-	9.53	F N A	Vial Top	0.6 - 1.5ml Vial/Tube
▼	M71-83-499	500	-	-	9.53	F N A	Vial Top	1.0 - 2.0ml Vial/Tube
▲	M71-84-499	500	22.86	12.70	-	F N A	Centrifuge, Cryo Vial, Eppendorf, PCR Tube	0.5 - 0.7ml Tube - 1.5 - 2.0ml Tube 0.6 ml Vial/Tube - 1.0 - 8.0ml Vial/Tube
◆	M71-98-499	500	25.40	9.53	9.53	F N A	Centrifuge, Cryo Vial, Eppendorf, PCR Tube, Vial, Vial Top	0.5 - 0.7ml Tube - 1.0 - 8.0ml Vial/Tube 0.6 - 1.5ml Vial/Tube

Order references beginning with "B" indicate bulk rolls.

Polyester Labels

- **B-423 Glossy White Polyester**
- **B-430 Glossy Clear Polyester**
- **B-488 Matt White Polyester**

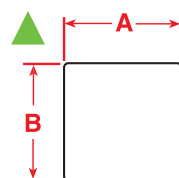

Diagram	Order Reference	Labels Per Roll	Label Width A (mm)	Label Height B (mm)	Environment	Application	Vial/Tube size
▲	M71-2-423	100	50.80	6.35	F A	Well Plate	
▲	M71-7-423	500	12.70	12.70	F A	Conical Tube, Bottles, Petri Dish, Deep Well Plate	50.0 ml Conical Tube/Bottles/Petri Dish/Deep Well Plate
▲	BM71-7-423	5000	12.70	12.70	F A	Conical Tube, Bottles, Petri Dish, Deep Well Plate	50.0 ml Conical Tube/Bottles/Petri Dish/Deep Well Plate
▲	M71-14-423	750	25.40	4.75	F A	Conical Tube, Bottles, Petri Dish, Deep Well Plate	50.0 ml Conical Tube/Bottles/Petri Dish/Deep Well Plate
▲	M71-15-423	750	25.40	6.99	F A	Conical Tube, Bottles, Petri Dish, Deep Well Plate	50.0 ml Conical Tube/Bottles/Petri Dish/Deep Well Plate
▲	M71-17-423	500	25.40	12.70	F A	Conical Tube, Bottles, Petri Dish, Deep Well Plate	50.0 ml Conical Tube/Bottles/Petri Dish/Deep Well Plate
▲	M71-17-430	500	25.40	12.70	F A	Conical Tube, Bottles, Petri Dish, Deep Well Plate	50.0 ml Conical Tube/Bottles/Petri Dish/Deep Well Plate
▲	M71-20-423	100	50.80	25.40	F A	Conical Tube, Bottles, Petri Dish, Deep Well Plate	50.0ml Conical Tube/Bottles/Petri Dish/Deep Well Plate
▲	BM71-20-423	1000	50.80	25.40	F A	Conical Tube, Bottles, Petri Dish, Deep Well Plate	50.0ml Conical Tube/Bottles/Petri Dish/Deep Well Plate
▲	M71-22-423	100	76.20	25.40	F A	Conical Tube, Bottles, Petri Dish, Deep Well Plate	50.0ml Conical Tube/Bottles/Petri Dish/Deep Well Plate
▲	M71-31-423	250	38.10	25.40	F A	Conical Tube, Bottles, Petri Dish, Deep Well Plate	50.0 ml Conical Tube/Bottles/Petri Dish/Deep Well Plate
▲	M71-80-488	250	19.05	22.86	F A	Slide	
▲	M71-81-488	750	48.26	6.35	F A	Well Plate	
▲	M71-97-488	250	22.86	22.86	F A	Slide	
▲	M71C-500-430	1 (cont.)	12.70	15.24M	F A	Conical Tube, Bottles, Petri Dish, Deep Well Plate	50.0 ml Conical Tube/Bottles/Petri Dish/Deep Well Plate

Order references beginning with "B" indicate bulk rolls.